



630047 Russia, Novosibirsk, Dargomyzhsky street, 8a
Tel./Fax +7 (383) 2286-491
e-mail: office@ekran-os.ru guquchkin@ekran-os.ru

IMAGE INTENSIFIER GEN II PLUS

EPM66G-2

Double Proximity Focused Image Intensifier with S25 multi-alkali photocathode on a 1,2mm glass input window, microchannel plate and a phosphor screen on a 1,2mm glass output window. Image Intensifier incorporates a high voltage power supply which automatic brightness control(ABC) and bright source protection(BSP). A hole pitch (pitch (distance between centers of the channels) of the microchannel plate is 12,5 microns**. Power connectors are flying leads.

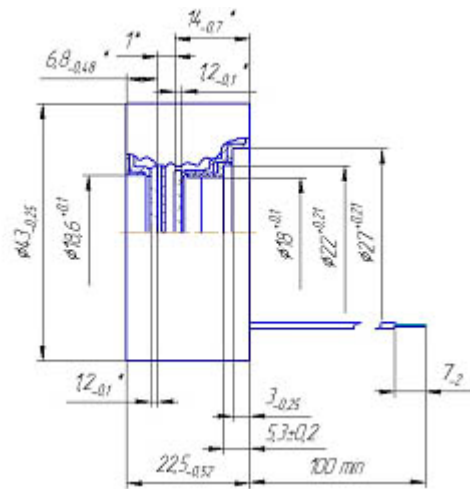
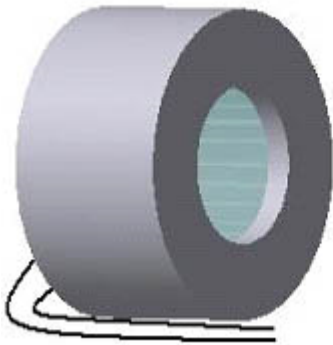

SPECIFICATION

	EPM 66 G- 2	Typical value
Useful diameter	18	
Nominal operating voltage , ?	3±0.5	
Supply current , mA max	20	1 6
Photocathode sensitivity:		
-white light , ?? /lm	450	500
-at 850 nm, mA/W	24	30
Resolution lp/mm , min	43	4 5
Luminous gain at 100 µlx	20000 - 25 000	23 000
Signal to Noise Ratio min	18	19
Max.Output Brightness at 10lx cd/m 2	4 - 8	6
Mean Time To Failure hours min	10000	10000
Modulation Transfer function		
2.5 lp/mm	0.8 3	0.88
7.5 lp/mm	0. 56	0.70
15 lp/mm	0. 30	0.42
Shock Acceleration m/s 2	5000	
Operating Temperature ° ? min/max	-50/+50	
* * <i>The export license not required</i>		